

"SF" STYLE COMPANION FLANGE

SPECIAL OVER-SIZED COMPANION FLANGE WITH ADAPTER PLATE

FRICION CONNECTION

FACEKEY CONNECTION

HIRTH-SERRATION CONNECTION

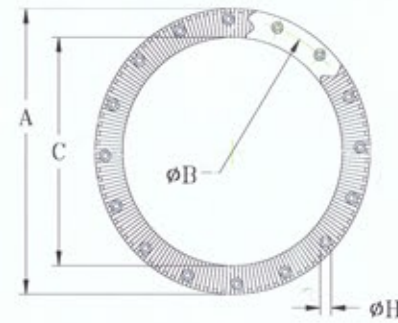
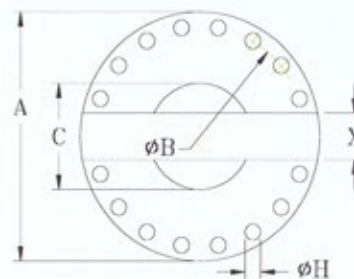
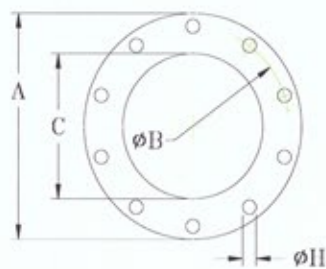

TYPICAL SHREDDER APPLICATIONS

POWER*		1500 HP	2000 HP	3000 HP	3500 HP	4000 HP	5000 HP	7000 HP	9000 HP
GWB SIZE*		390.70	390.75	390.80	392.75	393.80	393.85	393.90	492.90
T_{FL}	Nm	130,000	190,000	255,000	390,000	580,000	750,000	1,150,000	1,300,000
T_{FT}	Nm	74,200	105,000	142,800	196,000	30,8000	399,000	609,000	840,000
Std.Length		Variable	Variable	96"	96"	96"	96"	96"	146"
Flange	A mm	350	390	435	390 / 435	435	480	550	550
Type		Friction	Friction	Friction	Facekey / Friction	Facekey	Facekey	Facekey	Hirth-Serration
Slip	Inch	+/- 2.65"	+/- 3.35"	+/- 3.35"	+/- 3.35"	+/- 3.35"	+/- 3.74"	+/- 4.13"	+/- 4.13"
Rec. max Angle	α deg	5	5	5	5	5	5	5	5
Swing	K mm	300	330	370	390	435	480	550	550
BC	B mm	310	345	385	345 / 385	385	425	482	510
Pilot	C mm	220	250	280	170 / 280	190	205	250	N/A
Thickness	G mm	25	28	32	40	42	47	50	65
Boltholes	H mm	22.1	24.1	27.1	25 / 27.1	28	31	31	23
# of bolts	I mm	10	10	10	10	16	16	16	16
End to cl	M mm	170	190	210	205	235	236	290	330
Key width	X mm	N/A	N/A	N/A	70 / N/A	80	90	100	N/A
Key height	Y mm	N/A	N/A	N/A	18 / N/A	20	22.5	22.5	N/A
Tubing	S Inch	8.75	10.75	11	11	13	14.38	16.5	18
Spline dia.	W mm	150	185	185	185	210	210	240	290
Driveshaft Inertia*	Lbs*ft ²	93	142	269	440	637	898	1784	2900
Driveshaft Stiffness*	Deg / 1000 ft*lbs	0.04265	0.03049	0.02003	0.01471	0.01064	0.00890	0.00572	.00429

T_{FL} = Functional Limit Torque; T_{FT} = Pulsating Fatigue Limit Torque

* Above values are general guidelines only. Driveline sizes may vary depending specific application numbers. Inertia and stiffness vary with length and tube sizes. All selections need to be verified with MSI Engineering. Please see "Shredder Application Data" worksheet for required information