

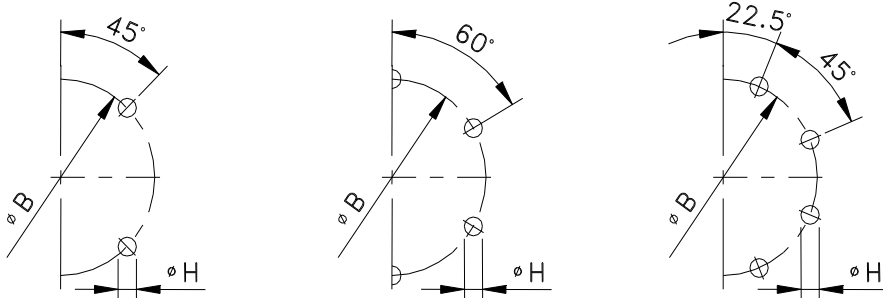

**TS**

with length compensation, tubular design

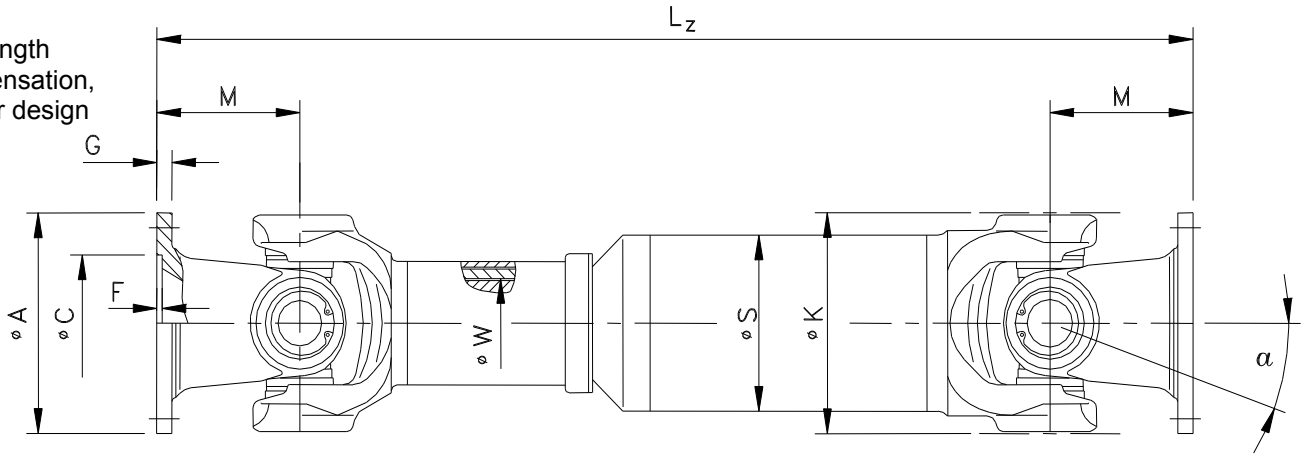

**T**

without length compensation, tubular design

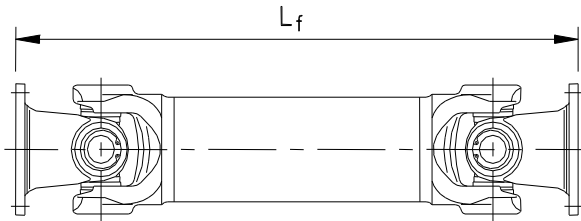

**SC1 SC2**

**SC3 SC4**

with length compensation, short design

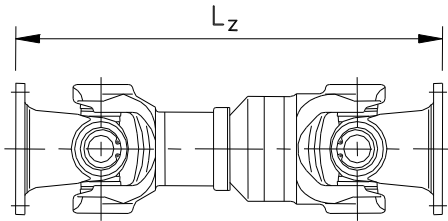

**FF**

without length compensation, double flange shaft design

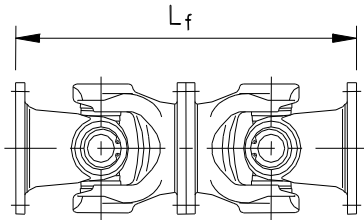



<b>MSI SERIES</b>	<b>615090</b>	<b>615100</b>	<b>620120</b>	<b>625120</b>	<b>625150</b>	<b>630120</b>	<b>630150</b>	<b>635150</b>	<b>635180</b>	<b>640150</b>	<b>640180</b>
-------------------	---------------	---------------	---------------	---------------	---------------	---------------	---------------	---------------	---------------	---------------	---------------

**Capacity:**

T <sub>FL</sub>	Nm	2400	3500	5000	6500	10000	14000
T <sub>K</sub>	Nm	1800	2700	3800	5000	7700	10500
T <sub>FT</sub>	Nm	700	1000	1600	1900	2900	4400
T <sub>C100</sub>	Nm	700	960	1400	1550	2500	3550
T <sub>C1000</sub>	Nm	350	480	700	775	1250	1775

T<sub>FL</sub> = Functional Limit Torque; T<sub>K</sub> = Catalog Torque; T<sub>FT</sub> = Fatigue Torque (reversing applications)

T<sub>C100</sub> = Continuous Torque at 100 RPM, 3 deg and 20,000 hours B-10 Bearing Life

T<sub>C1000</sub> = Continuous Torque at 1000 RPM, 3 deg and 20,000 hours B-10 Bearing Life

**Dimensions:**

Flange	A	mm	90	100	120	120	150	120	150	150	180	150	180
Angle	□	Deg	35	25	25	25	25	25	25	25	25	25	25
Swing	K	Mm	90		98	113		127		142		158	
BC	B	Mm	74.5	84	101.5	101.5	130	101.5	130	130	155.5	130	155.5
Pilot	C	Mm	47	57	75	75	90	75	90	90	110	90	110
Depth	F	Mm	2.5	2.5	2.5	2.5	2.5	2.5	2.5	3	3	3	3
Thickness	G	Mm	6	7	8	8	8	8	10	10	12	10	12
Boltholes	H	Mm	8.25	8.25	10.25	10.25	12.1	10.25	12.1	12.1	14.1	12.1	14.1
# of bolts	I	Mm	4	6	8	8	8	8	8	8	8	8	8
End to cl	M	Mm	52	48	54	70	60	72	75	95	90	102	102
Tubing	S	Inch	2.000 x .095	2.500 x .095	3.000 x .095	3.500 x .095		3.500 x .134		4.000 x .156		4.750 x .188	
Spline	W	Mm	36x1.5		40x1.5	45x1.5		48x1.5		54x1.5		62x1.75	

**Length Variations [mm]:**

Design \ Series	615090	615100	620120	625120	625150	630120	630150	635150	635180	640150	640180	
<b>TS</b>	Min. Length L <sub>z</sub>	354	346	379	438	418	504	514	582	572	586	586
	Slip	60	60	70	100	100	110	110	110	110	110	110
<b>T</b>	Fixed Length L <sub>f</sub>		221	239	262	242	322	332	379	369	423	423
<b>SC 1</b>	Length L <sub>z</sub>		308	381	405	360		415	550			545
	Slip		50	60	80	55		60	110			110
<b>SC 2</b>	Length L <sub>z</sub>		348	341					485			
	Slip		90	60					45			
<b>SC 3</b>	Length L <sub>z</sub>	249	265	276	325		347		424		476	441
	Slip	25	45	29	40		45		50		80	45
<b>SC 4</b>	Length L <sub>z</sub>						331				441	
	Slip						29				45	
<b>FF</b>	Length L <sub>f</sub>	204	192	216	280	240	288	300	380	360	408	408

Please verify all drive shaft selections with MSI engineering.

Flange may have to be reinforced to transmit max. torque.

**Longer Slip and High Angle** versions are available.

Above listed are standard metric flange patterns. **Special Flange Patterns** are available upon request.

Weights, torsional stiffness and inertia information can be supplied.

Please consult **MSI engineering**.